



NEW



NEW



NEW



NEW

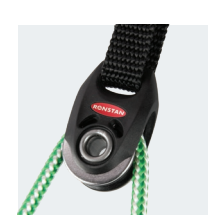

RF21107 with webbing attachment

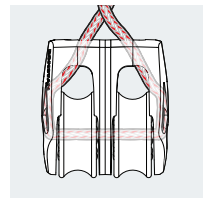
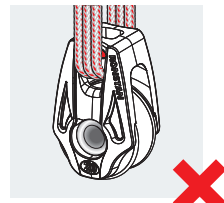
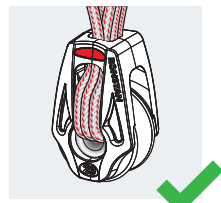

Lashing line must pass through the hub with a tight splice in the head or cross over before lashing to a fixing point.

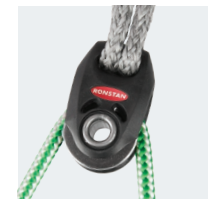
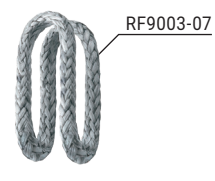

RF21107 with Dyneema® link attachment

- ☑ Ball bearing blocks have a 2-stage ball bearing system.
- ☑ Hollow hub for becket take-off.
- ☑ Suit up to 4mm (5/32") lashing.
- ☑ RF25109HL & RF25209HL ideal for higher load applications.
- ☑ Dyneema® lashing line supplied with singles RF25109 & RF25109HL.
- ☑ RF21107 suits up to 10mm (3/8") webbing or RF9003-07 Dyneema® link.
- ⚙ Control lines.
- ⚙ Leech lines & cunninghams.
- ⚙ Cascading vang.
- ⚙ Kite bridles.
- ⚙ BB Sheave: High compression strength acetal.
- ⚙ HHL sheave and bearing race: Grade 2205 stainless steel, ball bearings: Grade 304 stainless steel.
- ⚙ Frame/cheeks: Toughened nylon.
- ⚙ Load straps (RF21107): Grade 316 stainless steel.
- ⚙ Frame/cheeks (RF21107): Toughened, glass fibre reinforced nylon.

PRODUCT No.	DESCRIPTION	SHEAVE DIAM. mm	MAX. ROPE mm	M.W.L. kg	B.L. kg	WEIGHT g	SHEAVE DIAM. in.	MAX. ROPE in.	M.W.L. lb	B.L. lb	WEIGHT oz
BB Ball Bearing											
RF21107	Single block, becket hub, suits 10mm (3/8") webbing	20	5	200	400	14	3/4	3/16	440	880	0.5
RF25109	Single block, becket hub, incl. 750mm (30") x 1.7mm (1/16") diameter, Dyneema® lashing line	20	6	250 ^{*1}	550	9	3/4	1/4	550 ^{*1}	1210	0.3
RF25209	Double block, becket hub	20	6	300 ^{*2}	800	14	3/4	1/4	660 ^{*2}	1760	0.5
RF25309	Triple block, becket hub	20	6	300 ^{*2}	800	21	3/4	1/4	660 ^{*2}	1760	0.7
RF25151	Cheek block	20	6	250	550	8	3/4	1/4	550	1210	0.3
HHL High Grade Stainless Steel Sheave											
RF25109HL	Single block, becket hub, incl. 750mm (30") x 2.0mm (3/32") diameter, Dyneema® lashing line	20	6	300 ^{*1}	900	14	3/4	1/4	660 ^{*1}	1980	0.5
RF25209HL	Double block, becket hub, HHL	20	6	450 ^{*2}	900	26	3/4	1/4	990 ^{*2}	1980	0.9
Accessories											
RF9003-07	Dyneema® link to suit RF21107										

*1 Block must be lashed through hub. The supplied lashing line must have three passes through head and hub to achieve rated load.
*2 Both the MWL and BL are dependent on the strength of the line used to lash the block through the central hub. Refer to the SUPPORT page at www.ronstan.com for lashing instructions.